



BLUEBELL RAILWAY EDUCATION DEPARTMENT

E. Sheffield Park Station Museum

1. The Museum has many artefacts and displays about railways and transport in general. Sections of particular interest to schools are highlighted below. (See also floor plan below).

Victorian Ticket Office

2. A replica Victorian ticket office contains a number of period artefacts, including: an Imperial typewriter, a hand bell, old ledgers, Edmondson ticket dating press, railway tickets, letter and parcel scales, oil lamp and a candlestick telephone.

Origins and Preservation of the Line

3. The origin of the Lewes and East Grinstead line is described, illustrating the way that local industries, including agriculture and brickmaking benefited, as well as the story of the preservation of the line.

Pre-Railway Age

4. An interactive display table shows the development of transport links over the centuries, Roman roads, Turnpike roads, river and canal transport, to the railways of Sussex.

The Railway Pioneers

5. Displays explain how Victorian workers built the railways and a selection of the tools that were used is on view. Also pictures and text about the pioneer engineers who developed steam engines and built the railways – including internationally famous Victorian railwaymen such as Brunel, Stephenson and Watt as well as local ones.

The Golden Age

6. A period when travel by train and cross Channel ferry gradually became more comfortable and artefacts from that period are on display. These include items from the famous through Golden Arrow service from London to Paris, menus and tableware used in dining cars from the 1920s to the 1950s and well as guidebooks for travellers planning holidays in both Britain and Europe.

Withyham Signal Box

7. The fully restored Victorian signal box from Withyham Station can be viewed.

Railways in Wartime

8. The contribution made by Railway Companies and their staff during both world wars are recognised. For WWII these include: -

A Southern Railway poster about the evacuation of children from London.

Information and photographs about the organisation of the evacuations.

Posters enforcing the blackout and encouraging women to go to work on the railway.

An original letter from Sir Winston Churchill (the wartime Prime Minister) written after the war.

A letter from King George VI given to all schoolchildren in 1946.

Bluebell Railway Museum Floor Plan

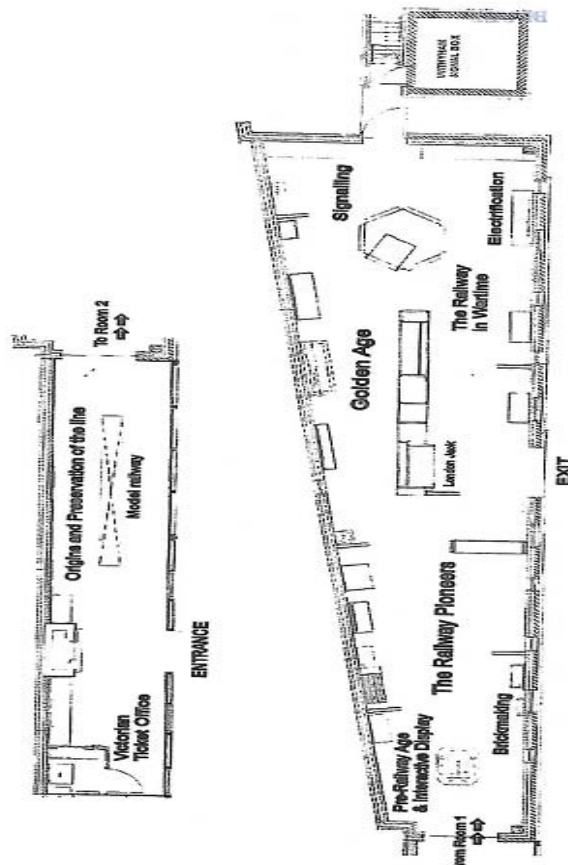

The Bluebell Railway Museum is located on platform 2 at Sheffield Park. There are toilets nearby on this platform.

SECOND DRAFT